



专业服务 创造价值
PROFESSIONAL SOLUTIONS CREATE MORE VALUE

上海工程机械厂有限公司
SHANGHAI ENGINEERING MACHINERY CO.,LTD.

地址: 中国上海市宝山区富锦路2655号/杨南路258号
销售热线: 021-56776562/56656718
配件销售: 021-56771749
外贸热线: 021-56036931
租赁热线: 021-56651055*2216
售后服务热线: 4008881749
售后服务监督热线: 021-56779934
电子邮箱: sales@semw.com
网址: www.semw.com

Add: 2655 Fujin Road / 258 Yangnan Road, Baoshan District, Shanghai, China
Sales Tel: + 86-21-56776562/56656718
Spare Parts Sales Tel: + 86-21-56771749
Foreign Trade Tel: + 86-21-56036931
Service Tel: 4008881749
Rental Tel: + 86-21-56651055*2216
Service Supervisor Tel: + 86-21-56779934
E-mail: sales@semw.com
Web site: www.semw.com



全回转式全套管钻机系列

Casing Rotator Series

上海工程机械厂有限公司
SHANGHAI ENGINEERING MACHINERY CO.,LTD.



SEMW
上工机械

2020年8月，上工机械正式收购徐州盾安资产，开启全回转式全套管钻机产品和技术发展新篇章。
SEMW formally acquired the assets of Xuzhou Dun An in August 2020, A new chapter in the product and technology development of Casing Rotator.



套管
Casing



液压动力站
Power pack



工作装置
Base Machine

百年上工，地下基础施工整体解决方案专家

Centennial SEMW, EXPERTISE IN DELIVERING TURNKEY SOLUTIONS TO DEEP FOUNDATION ISSUES.

C 企业简介 COMPANY CULTURE

上海工程机械厂有限公司成立于1921年

前身为上海工程机械厂。

Shanghai Engineering Machinery Co., Ltd. (SEMW)

—founded in 1921—

公司主要从事TRD系列工法机、静钻根植系列工法钻机、全回转式套管钻机、DCM系列海上、陆上处理系统、双轮搅拌钻机、多功能套管螺旋钻机、SMJ履带式钻机、多轴式连续墙系列钻机、全液压履带式、步履式系列打桩架、搓管机、筒式系列柴油锤、电驱振动锤、液压系列打桩锤、高空作业平台等地下基础施工机械产品的设计、制造和销售。可为高速公路、高层建筑、桥梁、地铁、机场、码头、电站等特大型工程的基础施工提供机械设备和整体解决方案。

公司产品除提供国内市场外，还出口到北美、欧洲、南美、非洲及东南亚各国，并获得中华人民共和国进出口企业资格证书。

SEMW is specialist manufacturing of pile driving and deep foundation equipment. SEMW currently produces Trench Cutting & Re-mixing Deep Wall Method Equipment, SDP110 Pre-bored Pre-cast Piling Equipment, CRD-200H full casing rotary drilling rig, DCM Series offshore and land Processing System, Double Wheel Agitator Rig, DRA Series Dual Power Rotary Auger, SMJ Pile Driving Rig, Multi-shaft Agitating Augers, Hydraulic Pile Driving Rigs & Walking Piling Rig, PIT300 rammed shaft casing oscillators, D series Diesel Pile Hammer, Vibratory Hammer, HM Series Hydraulic Hammer, Boom Lifts. SEMW provides mechanical equipment and Turnkey solutions for the foundation construction of super large projects such as expressways, high-rise buildings, bridges, subways, airports, docks and power stations.

Our equipments are well received both domestically and overseas, in addition to providing domestic market, also exported to North America, Europe, South America, Africa and southeast Asia countries, and has obtained the People's Republic of China import and export enterprise qualification certificate.

主要结构

Main Structure

1 楔形夹紧装置 Wedge shape clamr

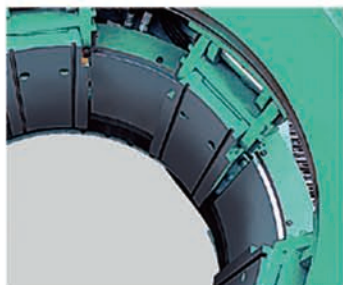

与传统夹紧机构相比，无论在什么位置都能夹紧套管，并使套管保持较高的垂直精度，而且套管的拉拔力越大，夹紧力也就越大。
The Wedge shape clamping mechanism can clamp every position of the casing surface and keep the vertical accuracy of the casing. It is designed with high performance delivery efficiency.

2 马达减速机 Motor reduction gear



多套马达减速机可以提供足够的扭矩，传递给套管强大的回转力，可适应复杂的地层及切削障碍物。
Multiple sets of motor reducer can supply the sufficient torque, transfer a strong rotary force to the casing, which can adapt to the complicated stratum and cut obstructions.

3 垂直装置 Leveling jack



液压垂直装置，保证施工中钻孔的垂直度。
Hydraulic leveling Jack device ensures the verticality of drill holes.

4 口径变更装置 Reducer



方便的口径变更使得设备适用于多种口径的变更要求。
The reducer makes the equipment adapt to various requirements of casing diameter.

5 辅助夹紧装置 Sub-clamr

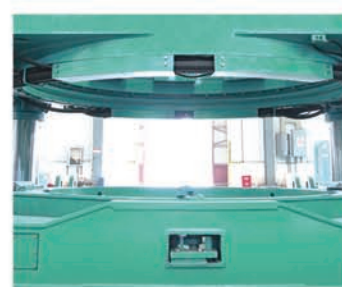

能更好的保证套管的垂直度，同时在大深度挖掘时弥补配套起重机的起吊能力不足的问题。
It can better ensure the verticality of casing, and additionally compensate for the problem of low crane capacity of the equipped crane during deep excavation.

6 工作行走装置 (选装) Traveling device



履带式行走装置，液压横向伸缩功能，可使设备在场地上方便自行移动及桩心定位。
The crawler traveling device is with the function of hydraulic transverse expansion, which is convenient for the equipment to move automatically and conduct the pile core localization.



工作装置
Base machine

主要结构

Main Structure

1 发动机 Engine



发动机巨大的功率能够给设备提供巨大的扭矩，使得机器获得强大的扭矩，能够适应任何复杂困难的地层。
 The great power of engine can supply a huge torque of the equipment. It provides the machine with a great torque and make it adapt to any complicated and difficult stratum.

2 方便的操控系统 Remote Control box



微电脑的操控平台，可根据工况调节转速、扭矩、压入力，使机器处于最佳工作状态，极大提高了工作效率。
 According to the working condition the operating system platform of micro computer can keep the machine at an optimum working state by adjusting the speed, torque and pressing force, and promote the work efficiency to the maximum.

3 刀头载荷自动控制系统 Cutter head load automatic control system



在切削硬岩时，通过电脑的自动控制，能够很好的保护刀头，提高切削效率。
 When cutting the hard rock, it can well protect the cutter head, enhance the cutting efficiency by the automatic control of computer.

4 瞬间增强系统 Emergency boost Circuit

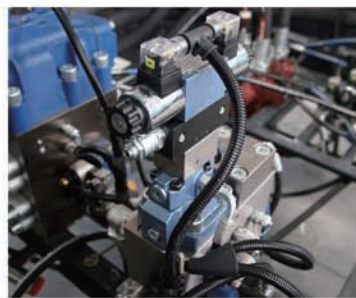

在碰到障碍物时，可瞬间加大起拔力和扭矩，使得障碍物得到排除。
 When encountering obstructions, it can instantly enhance the pulling force and torque to clear the obstruction.

5 应急系统 Emergency control system



在动力站上设置控制系统的应急模块，出现故障时，可使用应急系统完成施工作业。
 The emergency module control system is also set in the power station. When there is a malfunction, the emergency system can be adopted to complete the construction work.

6 动力站行走装置（选装） Power pack station traveling



方便行走的动力站，使设备在施工现场能够自如的行走，能够很好的完成动力站的转移工作；其支撑结构在工作时能够保证设备的平稳及安全。
 The traveling, which is convenient for traveling, can make the equipment travel freely on the construction site and complete itself transfer; the support structure can ensure the stability and safety of equipment during working.



发动机
Engine



遥控盒
Remote control



液压动力站
Hydraulic power pack

这是一种新型、环保、高效的钻进技术，近年来在城市地铁、深基坑围护咬合桩、废桩（地下障碍）的清理、高铁、道桥、城建桩的施工、水库水坝的加固等项目中得到了广泛的应用。

这种全新的工艺工法的研究成功，实现了施工人员在卵、漂石地层、含溶洞地层、厚流沙地层、强缩颈地层、各类桩基础、钢筋砼结构等障碍还没有清除的情况下就可以实现灌注桩、置换桩、地下连续墙等各类桩基础施工的可能。

全回转式全套管工法已在世界多个国家及地区如：新加坡、日本、香港地区、上海、杭州、北京、天津、成都等地成功的完成了5000多个项目的施工任务。它一定会在今后的城市建设及其他的桩基施工领域发挥更大的作用。

① 大深度挖掘

- ◆为深层地基改良进行就地灌注或钢管桩插入
- ◆在水库、隧道施工中挖掘施工用深井

② 基础柱、连续墙

- ◆高铁、道桥、房建基础桩
- ◆需大开挖的地铁站台、地下建筑、连续墙的咬合桩施工
- ◆水库加固的挡水墙

③ 清除地下障碍物

- ◆在城市建设、桥梁改建时，可以直接清除钢筋混凝土桩、钢管桩、H钢桩、pc桩、木桩等障碍物，就地灌注基础桩

④ 钻进卵石、漂石、溶洞

- ◆可在山地等有卵、漂石的地层施工基础桩
- ◆可在沿海有厚流砂、强缩颈的地层或回填层进行作业，灌注基础桩

⑤ 切削岩层

- ◆对岩层进行嵌岩钻孔，灌注基础桩切削岩层
- ◆为就地灌注桩进行嵌岩钻孔
- ◆对岩床钻通孔（竖井、通风孔）

The casing rotator is a new type drill with the integration of the full hydraulic power and transmission, and the combination control of machine, power and fluid. It is a new, environmental and highly efficient drilling technology. In recent years, it is widely adopted in the projects such as the constructions of urban subway, articulation pile of deep foundation pit enclosure, clearance of waste piles (underground obstructions), high-speed rail, road and bridge, and urban construction piles, as well as the reinforcement of reservoir dam.

The successful research of this brand new process method has realized the possibilities for the construction workers to conduct the construction of casting pile, displacement pile, and underground continuous wall, as well as the possibilities for the pipe-jacking and shield tunnel to pass through the various pile foundations without barriers, when the obstructions, such as the gravel and boulder formation, cave formation, thick quicksand stratum, strong necking down formation and various pile foundation.

The construction method of casing rotator has successfully completed construction missions of more than 5000 projects at places of Singapore, Japan, Hongkong District, Shanghai, Hangzhou, Beijing, Tianjin and Chengdu. It certainly will play a bigger role in the future urban construction and other pile foundation construction fields.

① Deep boring

- ◆Conduct the in-place casting or steel pipe pile inserting for the deep foundation improvement.
- ◆Excavate deep wells for construction use in the constructions of reservoir and tunnel.

② Secant pile:

- ◆Foundation piles for high-speed rail, road and bridge and house building
- ◆Articulation pile constructions which are required to be excavated, such as subway platforms, underground architectures, continuous walls
- ◆Water retaining wall of reservoir reinforcement

③ Obstrucles removal work

- ◆During the urban construction and bridge rebuilding, the obstructions such as the steel reinforced concrete pile, steel pipe pile, H steel pile, pc pile and wood pile can be cleared directly, and cast the foundation pile on the spot.

⑤ Cut the rock stratum

- ◆Conduct the rock-socketed drilling to the cast-in-place piles.
- ◆Drill through-holes on the rock bed (shafts and ventilation holes)

④ Drilling gravels, boulders and karst caves

- ◆It is allowable to conduct the foundation piles construction at mountain lands with gravel and boulder formations.
- ◆It is allowable to conduct operation and cast the foundation piles at the thick quicksand formation and necking down stratum or the filling layer.
- ◆Conduct rock-socketed drilling to the rock stratum, cast the foundation pile

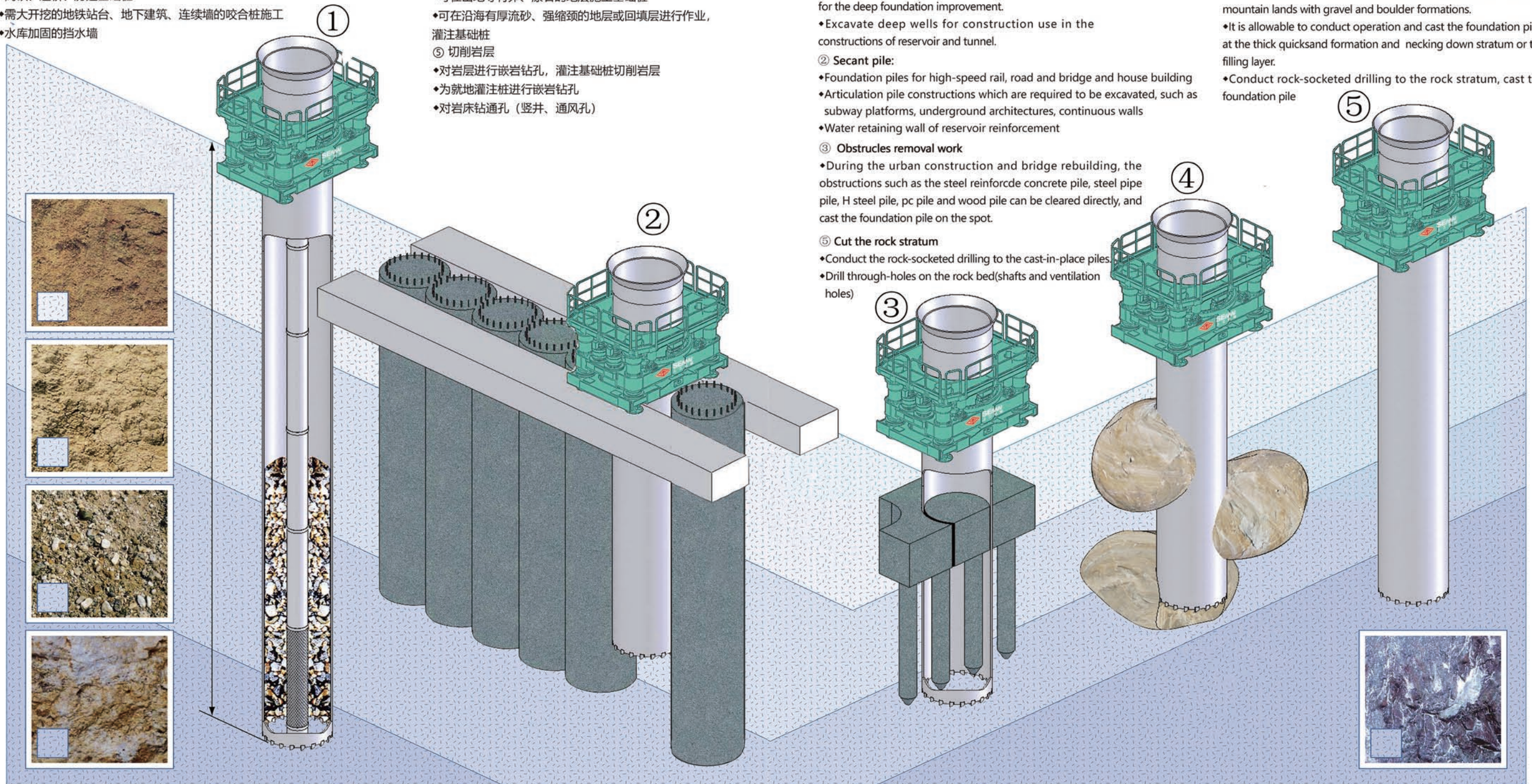

CRD系列全回转式全套管钻机
CRD series casing rotator



辅助机具 清除障碍物
Auxiliary Machines Remove the obstruction

多头爪 + 螺旋钻头
Multi linked gripper & Screw Head

- ◆根据需要，多头爪可以选配旋挖钻头和螺旋钻头。
- ◆低噪音、低振动的状态下工作。
- ◆能够选择悬吊钢丝绳的根数，因此可用小型起重机配合作业。
- ◆The multi linked gripper can grip with in side of the casing surface and drive the screw head by casing rotation.
- ◆It is particularly worth nothing that operation low noise and low vibration.
- ◆This device is optional equipment under requirements from CRD user.



多头爪 + 旋挖钻斗
Multi linked gripper+ Bucket

多头爪是一种套管内部挖掘装置，在清除钢筋混凝土、钢桩及破碎块石等地下障碍物时发挥巨大威力，它能有效地传递套管的扭矩、压入力。
The multi linked gripper can grip with in side of the casing surface and drive the bucket by casing rotation. It is particularly worth nothing that operation low noise and low vibration.
*This device is optional equipment under requirements from CRD user.

冲抓斗 + 重锤
Hammer Grab+Chisel

在岩层或有混凝土桩体冲抓斗不能冲挖时，用重锤反复冲击，破碎后用冲抓斗挖掘。
这是经常用到的冲抓斗和重锤配合作业的工法。
This is conventional method to break through the rock stratum or reinforced concrete pile, obstacles. Breakdown the rock or concrete by chisel and remove out these debris by hammer grab continuously.

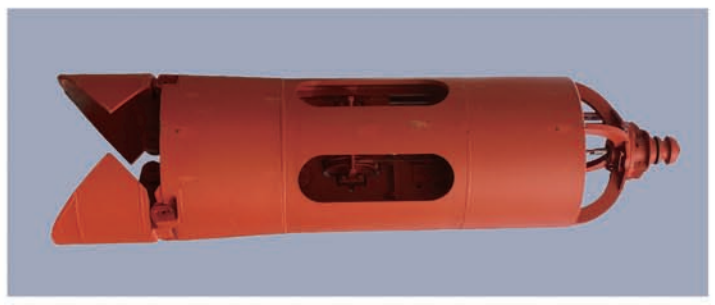

冲抓斗
Hammer Grab

冲抓斗是主要的套管内部冲挖装置，依靠吊机的大小吊钩配合来完成冲挖作业。
◆作业时冲抓斗沿套管内壁自由落下，下落速度快、冲击力强，硬质地层可直接冲挖，作业效率高。
◆斗刃成圆弧形，且斗体重，可实现水下冲挖。
◆内置滑轮组，抓紧力随起吊力的增加而成倍增加。
The hammer grab is common excavation device inside of the casing in this method and it is suspended with main drum wire to impact by free fall and excavate the soil or debris. The grabbing shell is round shape and operated by auxiliary drum wire. Penetration speed is quite high speed by free fall and can use under water situation. Structure of the rigging is effective for enforcing grabbing power.

功能强大 用途广泛

该设备的应用领域主要涉及地下障碍物（包括旧的混凝土预制桩、灌注桩、钢管桩、钢板桩等）的拔除和置换，城市和沿海地区软基或硬岩地区钻进成孔、复杂破碎的填石填海地层、沿海滩涂和地下水丰富的砂层、卵砾石地层、喀斯特地层的灌注桩施工。

工法技术灵活多样

机械化程度高

具有施工安全

可靠,成孔垂精度高

无泥浆污染等



全回转式全套管钻机优势

The advantages of casing rotator

采用全回转式全套管钻机施工的优势
The advantages of adopting the casing rotator for construction

- ▲低噪音，低振动，安全性高；
- ▲不使用泥浆，作业面干净，环保性好，并避免了泥浆进入砼中的可能性，成桩质量高，有利于提高砼对钢筋的握裹力；
- ▲施工钻进时可以很直观的判别地层及岩石特性；
- ▲钻进速度快，对于一般土层，可达14m/小时左右；
- ▲钻进深度大，根据土层情况，最深已达158m；
- ▲成孔垂直度便于掌握，垂直度可以精确到1/500；
- ▲不会产生塌孔现象，成孔质量高；
- ▲成孔直径标准，充盈系数小，与其它成孔方法相比，可节约大量的砼用量；
- ▲清孔彻底，速度快，孔底钻渣可清至3.0cm左右。

- ▲ Low noise, Low vibration, and high safety;
- ▲ Without mud, clean working surface, good environmental friendliness, avoiding the possibility for mud to enter the concrete, high pile quality, enhancing the bond stress of concrete to the steel bar;
- ▲ During construction drilling, the characteristics of stratum and rock can be directly distinguished;
- ▲ The drilling speed is fast and reaches about 14m/h for the general soil layer;
- ▲ the drilling depth is large and reaches about 158m according to the situation of soil layer;
- ▲ The hole forming verticality is easy to master, which can be accurate to 1/500;
- ▲ No hole collapse will be caused, and the hole forming quality is high.
- ▲ The hole forming diameter is standard, with little filling factor, Being compared with other hole forming methods, it can save a lot of concrete usage;
- ▲ The hole clearing is thorough and fast. The drilling mud at the hole bottom can be clear to about 3.0 cm.

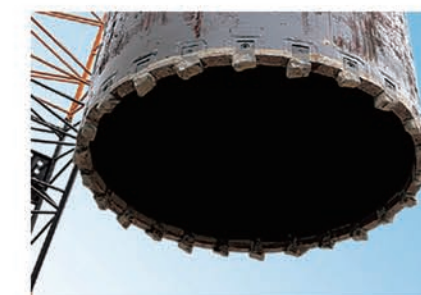

机器钻进效果

Drilling performance of machine



岩石钻进 Rock drilling

全回转式全套管钻机具有强大扭矩及压入力，可完成硬岩层中的施工任务。其可钻进的岩石硬度可达到：单轴抗压强度150-200MPa。
因其完美的切削性能，它在切割：砼块、高强螺栓、H桩、钢管桩等清障施工中得到广泛的应用。

The Casing rotator, with the strong torque and pressing force can complete the construction task in the hard rock formation. The rock hardness which can be drilled can reach: the uniaxial compressive strength of 150-200MPa; Because of the perfect cutting performance, it has been widely applied in the clearing constructions of cutting concrete blocks, high strength bolts, H piles and steel pipe piles.

穿过溶洞进行灌注桩施工 Drill through the karst cave and conduct the casing pile construction

全回转式全套管钻机在溶洞施工中有其它施工工艺无法比拟优势：它不需回填块石、不用另下套管。利用其自身良好的垂直度调节性能，钻速、钻压、扭矩的自动控制性能，可轻松的完成穿过溶洞的钻进任务。在进行溶洞中的砼灌注时，它是在套管内进行，添加了速凝剂的砼不易散失。且因钻机有强大的起拔力，还可延时起拔。所以，它可很好的完成溶洞中的灌注桩施工任务。

The casing rotator possesses an incomparable advantage than other construction technologies: there is no need to refill the rock block and use additional casing. With the good verticality adjusting performance, the self-control properties of drilling pressure and torque, It can easily complete the drilling work trough the karst cave. When conducting the concrete casting in the karst cave, the operation is conducted in the casing. So the concrete added with setting accelerator is not easily lost. And because of the powerful pulling force of the drill, the pulling can be delayed. So, it can well complete the cast pile constructon in the cave.

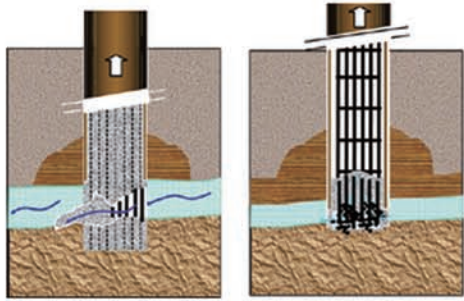

工作原理

自动控制装置 Automatic control device

Working Principle

自动控制装置即刀头载荷控制装置，通过微电脑的控制程序，控制推力液压油缸的压力，使刀头载荷不随套管重量、周围阻力的变化而变化，使机器处于最佳状态。

这是国际上最先进的自动控制系统，它是机、电、液一体的完美表现，它极大的提高了施工的安全性及工效。

The automatic control device, which is the cutter head load control device, controls the pressure of thrust hydraulic oil cylinder, makes the cutter head load not change with the changes of the casing weight and the surrounding resistance, and keeps the machine in its optimum working state.

This is the most advanced automatic control system in the world. it is a perfect representation of the intergrated machine, power and fluid, which has greatly enhanced the safety and working efficiency of the construction.

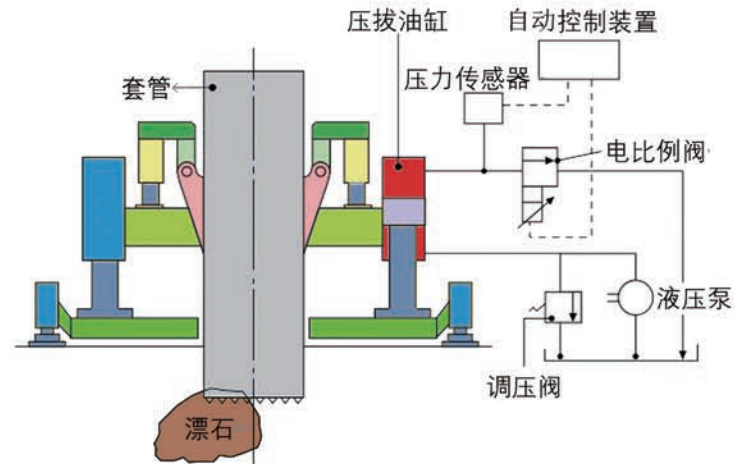

拔(去除)旧桩

原理及案例 Principle and examples

Pulling out (clearing) the old pile

全回转式全套管钻机拔除钢筋混凝土桩是其它机械无法完成施工。这种工法是用套管套住桩体进行切割作业，套管强大的回转扭矩可把桩体扭断，用冲抓斗取出。根据施工条件的不同，可用分割切除、整体拔除、重锤破碎及多头爪搅碎等工法清除。

The construction of adopting the casing rotator to pull out steel reinforced concrete piles cannot be completed by other machines. This construction method is: conduct the cutting work by using the casing to cover the pile body, then the strong rotary torque of casing can twist off the pile body and the impact-grab bucket grabs it out. According to different construction conditions, the construction methods of division cutting-off, entire pulling-out, heavy hammer breaking and multi-head claw mashing can be adopted for the clearing.

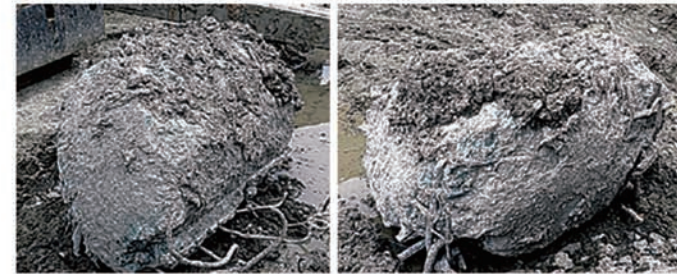

旋挖钻机与全回转

联合工法 Hybrid Drilling Method

Rotary drill and casing rotator

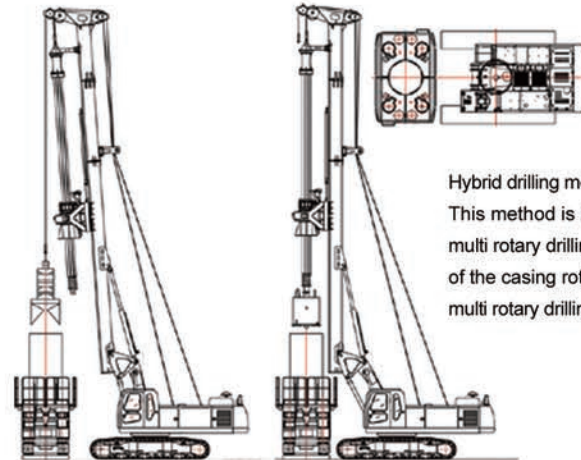

Hybrid drilling method

This method is hybrid method with the casing rotator and multi rotary drilling rig to create a best mix of the advantage of the casing rotator hard rock drilling performance and the multi rotary drilling rig excavation efficiency and cycle-time.

此工法是以全回转式全套管钻机作为主要的钻进机具，旋挖钻配合取土的工法，能很好的发挥全回转入岩和旋挖钻机快速取土的优点，极大地提高了工效。



CRD1305H 全回转式全套管钻机

Casing Rotator

工作装置主要技术参数:

钻孔直径	mm	Ø600~ Ø1300
回转扭矩	kN·m	1400/825/466瞬时1583
回转速度	rpm	1.6/2.7/4.8
套管下压力	kN	最大540
套管起拔力	kN	2440瞬时2690
压拔行程	mm	500
重量	ton	25 (含过渡架, 不含变径块)

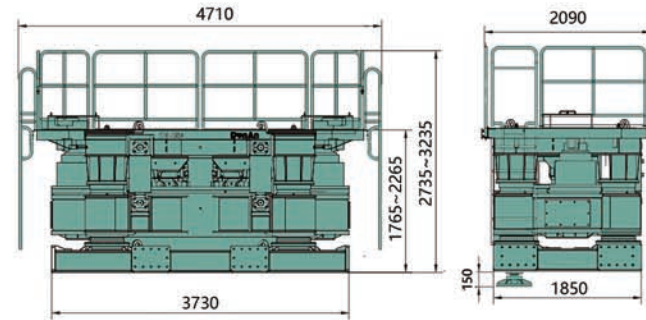

The main technical parameters of base machine:

Diameter of drill hole	mm	Ø600~ Ø1300
Rotary torque	kN·m	1400/825/466 Instantaneous 1583
Rotary speed	rpm	1.6/2.7/4.8
Lower pressure of sleeve	kN	Max540
Pulling force of sleeve	kN	2440 Instantaneous 2690
Pressure-pulling stroke	mm	500
Weight	ton	25 (With transition frame, without reducer blocks)

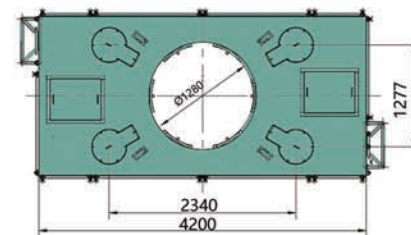

CRD1605H 全回转式全套管钻机

Casing Rotator

工作装置主要技术参数:

钻孔直径	mm	Ø800~ Ø1600
回转扭矩	kN·m	1525/906/512瞬时1744
回转速度	rpm	1.3/2.2/3.9
套管下压力	kN	最大560
套管起拔力	kN	2440瞬时2690
压拔行程	mm	500
重量	ton	28 (含过渡架, 不含变径块)

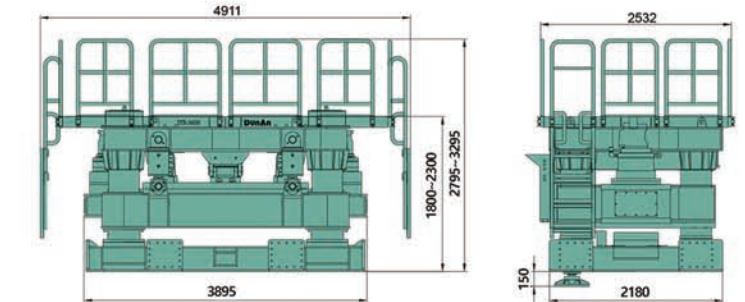

The main technical parameters of base machine:

Diameter of drill hole	mm	Ø800~ Ø1600
Rotary torque	kN·m	1525/906/512 Instantaneous 1744
Rotary speed	rpm	1.3/2.2/3.9
Lower pressure of sleeve	kN	Max560
Pulling force of sleeve	kN	2440 Instantaneous 2690
Pressure-pulling stroke	mm	500
Weight	ton	28 (With transition frame, without reducer blocks)

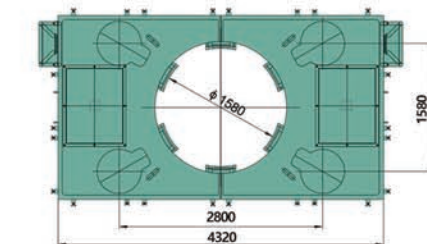

液压动力站主要技术参数:

发动机型号	东康 QSC8.3-C260	
发动机功率	kw/rpm	196/1800 (194/2200额定)
发动机燃油消耗率	g/kwh	194 (最大功率时)
重量	ton	8
控制方式	有线遥控 / 无线遥控	

The main technical parameters of power pack:

Engine Model	DCEC QSC8.3-C260	
Engine Power	kw/rpm	196/1800 (194/2200 rated)
Fuel consumption of engine	g/kwh	194 (when the maximum power rate)
weight	ton	8
Control mode	Wired remote control / wireless remote control	

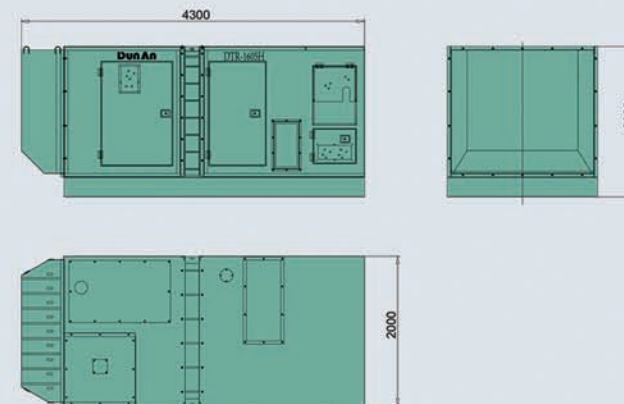

液压动力站主要技术参数:

发动机型号	东康 QSC8.3-C260	
发动机功率	kw/rpm	196/1800 (194/2200额定)
发动机燃油消耗率	g/kwh	194 (最大功率时)
重量	ton	8
控制方式	有线遥控 / 无线遥控	

Major technical parameters of hydraulic power pack:

Engine Model	DCEC QSC8.3-C260	
Engine Power	kw/rpm	196/1800 (194/2200 rated)
Fuel consumption of engine	g/kwh	194 (when the maximum power rate)
weight	ton	8
Control mode	Wired remote control/wireless remote control	

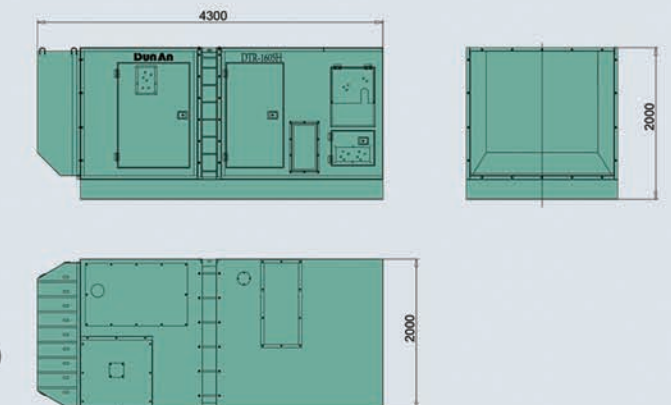

CRD1805H 全回转式全套管钻机

Casing Rotator

工作装置主要技术参数:

钻孔直径	mm	Ø1000~ Ø1800
回转扭矩	kN-m	2651/1567/885瞬时3005
回转速度	rpm	1.1/1.8/3.3
套管下压力	kN	最大600
套管起拔力	kN	3760瞬时4300
压拔行程	mm	500
重量	ton	38 (含过渡架, 不含变径块)

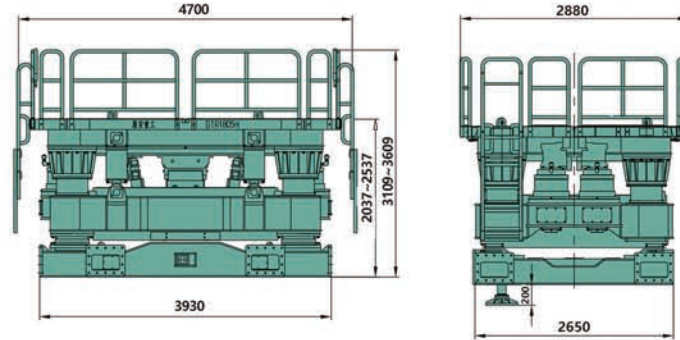

The main technical parameters of base machine:

Diameter of drill hole	mm	Ø1000~ Ø1800
Rotary torque	kN-m	2651/1567/885 Instantaneous 3005
Rotary speed	rpm	1.1/1.8/3.3
Lower pressure of sleeve	kN	Max600
Pulling force of sleeve	kN	3760 Instantaneous 4300
Pressure-pulling stroke	mm	500
Weight	ton	38 (With transition frame, without reducer blocks)

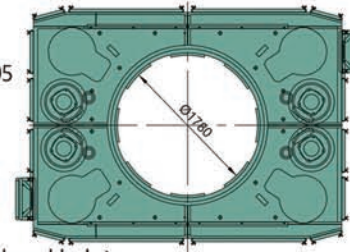

CRD2005H 全回转式全套管钻机

Casing Rotator

工作装置主要技术参数:

钻孔直径	mm	Ø1000~ Ø2000
回转扭矩	kN-m	2965/1752/990瞬时3391
回转速度	rpm	1.0/1.7/2.9
套管下压力	kN	最大600
套管起拔力	kN	3760瞬时4300
压拔行程	mm	750
重量	ton	46 (含过渡架, 不含变径块)

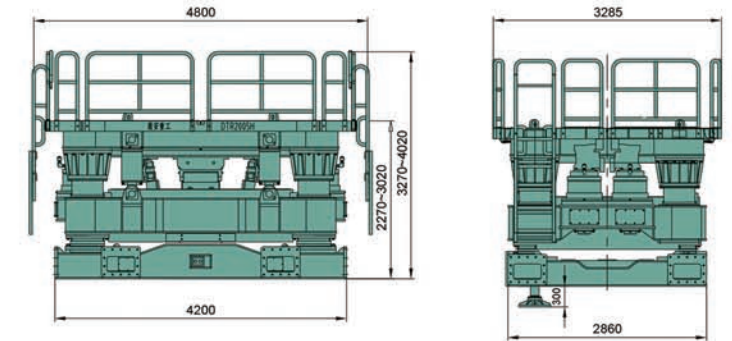

The main technical parameters of base machine:

Diameter of drill hole	mm	Ø1000~ Ø2000
Rotary torque	kN-m	2965/1752/990 Instantaneous 3391
Rotary speed	rpm	1.0/1.7/2.9
Lower pressure of sleeve	kN	Max600
Pulling force of sleeve	kN	3760 Instantaneous 4300
Pressure-pulling stroke	mm	750
Weight	ton	46 (With transition frame, without reducer blocks)

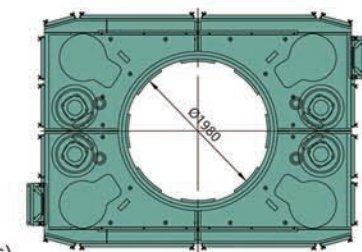

液压动力站主要技术参数:

发动机型号	康明斯 QSM11-335 沃尔沃TAD1152VE
发动机功率	康明斯 272/1800 (250/2100额定) 沃尔沃 285/1700 (271/2000额定)
发动机燃油消耗率	康明斯 216 (最大功率时) 沃尔沃 205 (最大功率时)
重量	8
控制方式	有线遥控/无线遥控

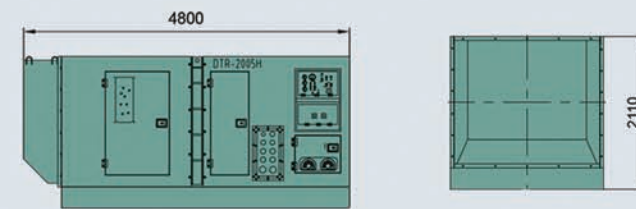

Major technical parameters of hydraulic power pack:

Engine Model	Cummins QSM11-335 Volvo TAD1152VE
Engine Power	Cummins 272/1800 (250/2100 rated) Volvo 285/1700 (271/2000 rated)
Fuel consumption of engine	Cummins 216 (when the maximum power rate) Volvo 205 (when the maximum power rate)
weight	8
Control mode	有线遥控/无线遥控

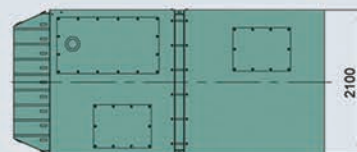

液压动力站主要技术参数:

发动机型号	康明斯 QSM11-335 沃尔沃TAD1152VE
发动机功率	康明斯 272/1800 (250/2100额定) 沃尔沃 285/1700 (271/2000额定)
发动机燃油消耗率	康明斯 216 (最大功率时) 沃尔沃 205 (最大功率时)
重量	8
控制方式	有线遥控/无线遥控

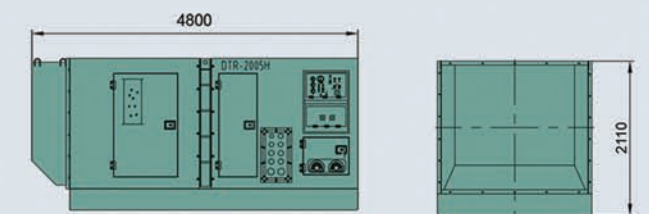

Major technical parameters of hydraulic power pack:

Engine Model	Cummins QSM11-335 Volvo TAD1152VE
Engine Power	Cummins 272/1800 (250/2100 rated) Volvo 285/1700 (271/2000 rated)
Fuel consumption of engine	Cummins 216 (when the maximum power rate) Volvo 205 (when the maximum power rate)
weight	8
Control mode	有线遥控/无线遥控

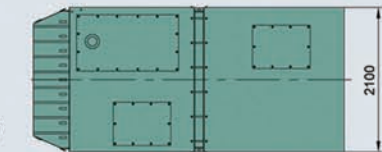

CRD2106H 全回转式全套管钻机

Casing Rotator

工作装置主要技术参数:

钻孔直径	mm	Ø1000~Ø2100
回转扭矩	kN·m	3085/1823/1030瞬时3505
回转速度	rpm	0.9/1.5/2.7
套管下压力	kN	最大600
套管起拔力	kN	3760瞬间4300
压拔行程	mm	500
重量	ton	48 (含过渡架, 不含变径块)

The main technical parameters of base machine:

Diameter of drill hole	mm	Ø1000~Ø2100
Rotary torque	kN·m	3085/1823/1030 Instantaneous 3505
Rotary speed	rpm	0.9/1.5/2.7
Lower pressure of sleeve	kN	Max.600
Pulling force of sleeve	kN	3760 Instantaneous 4300
Pressure-pulling stroke	mm	500
Weight	ton	48 (With transition frame, without reducer blocks)

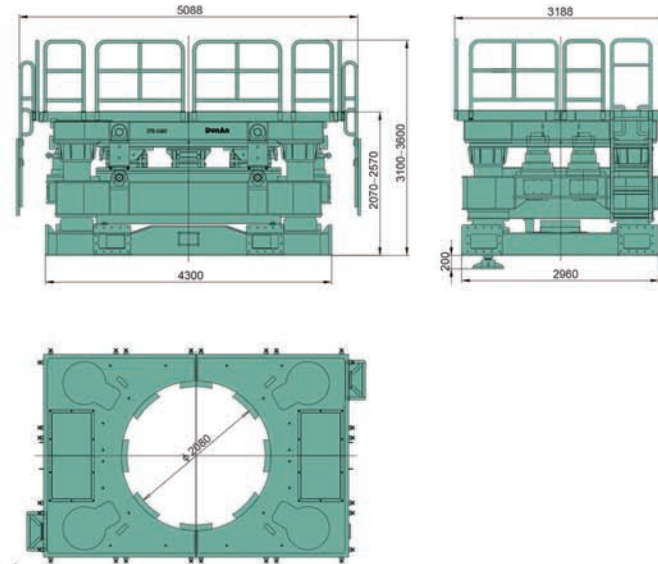

CRD2605H 全回转式全套管钻机

Casing Rotator

工作装置主要技术参数:

钻孔直径	mm	Ø1200~Ø2600
回转扭矩	kN·m	5292/3127/1766瞬时6174
回转速度	rpm	0.6/1.0/1.8
套管下压力	kN	最大830
套管起拔力	kN	4210瞬间4810
压拔行程	mm	750
重量	ton	56 (含过渡架, 不含变径块)

The main technical parameters of base machine:

Diameter of drill hole	mm	Ø1200~Ø2600
Rotary torque	kN·m	5292/3127/1766 Instantaneous 6174
Rotary speed	rpm	0.6/1.0/1.8
Lower pressure of sleeve	kN	Max.830
Pulling force of sleeve	kN	4210 Instantaneous 4810
Pressure-pulling stroke	mm	750
Weight	ton	56 (With transition frame, without reducer blocks)

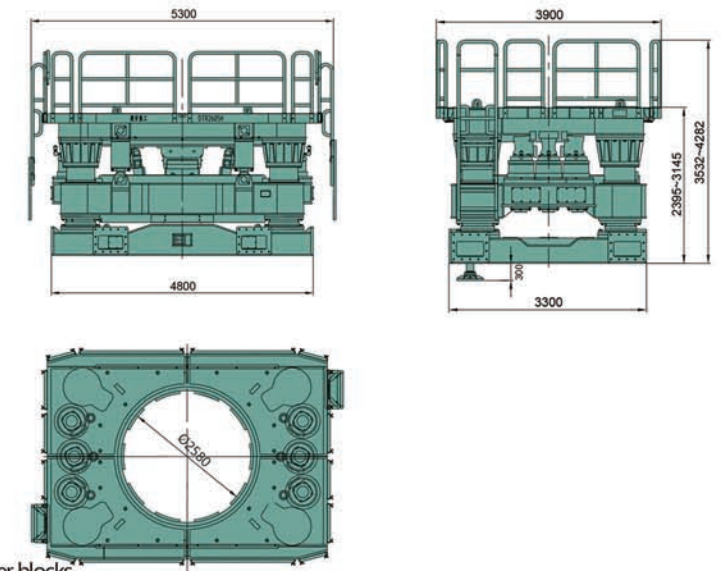

液压动力站主要技术参数:

发动机型号		康明斯 QSM11-335 沃尔沃 TAD1152VE
发动机功率	kw/rpm	康明斯 272/1800 (250/2100额定) 沃尔沃 285/1700 (271/2000额定)
发动机燃油消耗率	g/kwh	康明斯 216 (最大功率时) 沃尔沃 205 (最大功率时)
重量	ton	8
控制方式		有线遥控/无线遥控

Major technical parameters of hydraulic power pack:

Engine Model		Cummins QSM11-335 Volvo TAD1152VE
Engine Power	kw/rpm	Cummins 272/1800 (250/2100 rated) Volvo 285/1700 (271/2000 rated)
Fuel consumption of engine	g/kwh	Cummins 216 (when the maximum power rate) Volvo 205 (when the maximum power rate)
weight	ton	8
Control mode		有线遥控/无线遥控

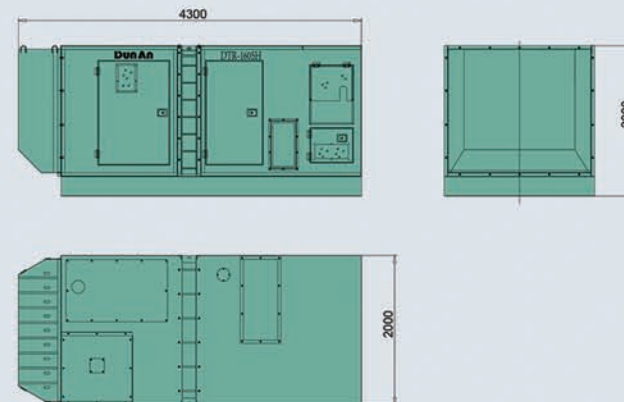

液压动力站主要技术参数:

发动机型号		康明斯 QSX15-500
发动机功率	kw/rpm	410/1800 (373/2100额定)
发动机燃油消耗率	g/kwh	217 (最大功率时)
重量	ton	10
控制方式		有线遥控/无线遥控

Major technical parameters of hydraulic power pack:

Engine Model		Cummins QSX15-500
Engine Power	kw/rpm	410/1800 (373/2100 rated)
Fuel consumption of engine	g/kwh	217 (when the maximum power rate)
weight	ton	10
Control mode		Wired remote control/wireless remote control

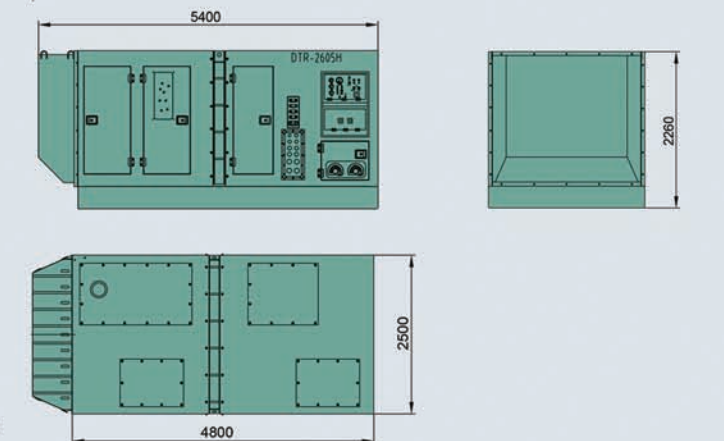

CRD3205H 全回转式全套管钻机

Casing Rotator

工作装置主要技术参数:

钻孔直径	mm	Ø2000~Ø3200
回转扭矩	kN·m	9080/5368/3034瞬时10593
回转速度	rpm	0.6/1.0/1.8
套管下压力	kN	最大1100
套管起拔力	kN	7237瞬时8370
压拔行程	mm	750
重量	ton	96(含楔形辅助夹紧、过渡架, 不含变径块)

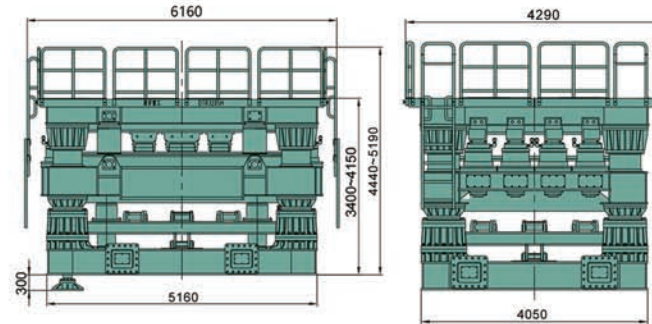

The main technical parameters of base machine:

Diameter of drill hole	mm	Ø2000~Ø3200
Rotary torque	kN·m	9080/5368/3034 Instantaneous 10593
Rotary speed	rpm	0.6/1.0/1.8
Lower pressure of sleeve	kN	Max.1100
Puling force of sleeve	kN	7237 Instantaneous 8370
Pressure-pulling stroke	mm	750
Weight	ton	96 (With wedge-shaped auxiliary clamping, transition frame, without reducer)

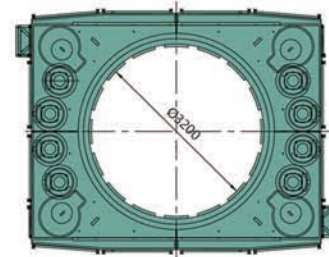

液压动力站主要技术参数:

发动机型号	康明斯 QSX15-500+东康QSC8.3-C260	
发动机功率	kw/rpm	410/1800 (373/2100额定) +196/1800 (194/2200额定)
发动机燃油消耗率	g/kwh	217+194 (最大功率时)
重量	ton	10+8
控制方式	有线遥控/无线遥控	

Major technical parameters of hydraulic power pack:

Engine Model	Cummins QSX15-500+DCEC QSC8.3-C260	
Engine Power	kw/rpm	410/1800 (373/2100 rated) +196/1800 (194/2200 rated)
Fuel consumption of engine	g/kwh	217+194 (when the maximum power rate)
weight	ton	10+8
Control mode	Wired remote control/wireless remote control	

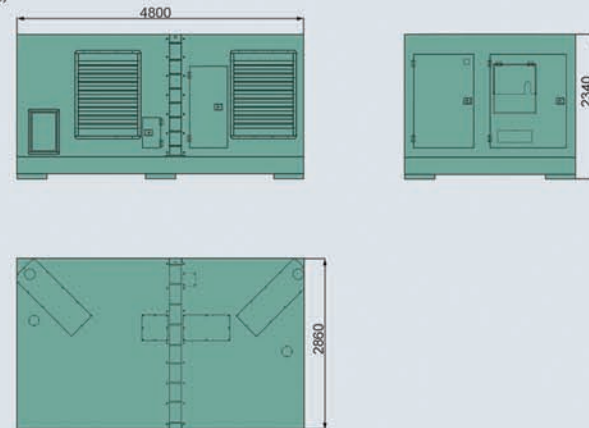

插钢立柱

Inserted steel column



1. 石家庄地铁一号线新世纪隆站施工
2. 南京中级人民法院项目施工
3. 北京地铁14号线平乐园站施工

1. 2. Construction of Steel Upright Post Vertical Insertion in New Century Long Station of Shijiazhuang Metro Line 1
3. 4. Project of Steel Upright Post Vertical Insertion at Nanjing Intermediate People's Court Project
5. Construction of Steel Upright Post Vertical Insertion at Pingleyuan Station of Beijing Metro Line 14



咬合桩

Occlusal pile

拔桩、清障

Pile pulling and
obstacle removal

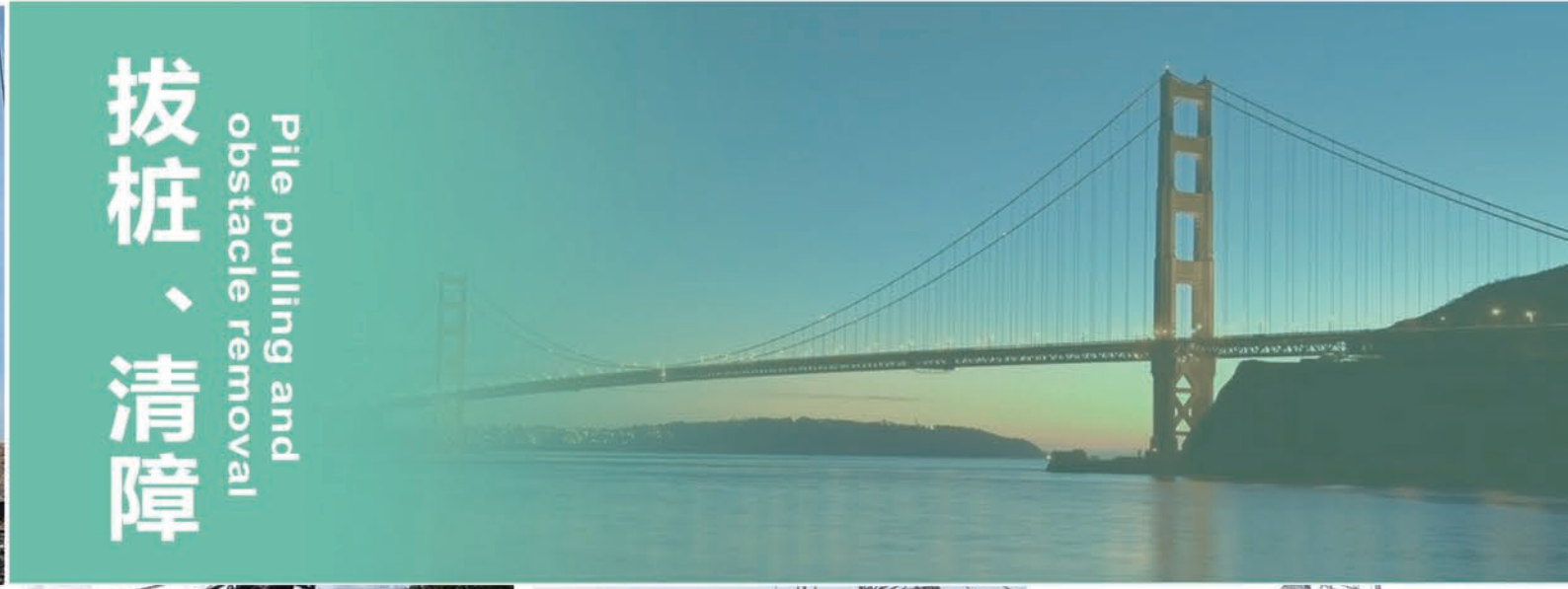

- 1
- 2
- 3
- 4
- 5

- 1. 福州圆形智能停车场工程
- 2. 大连湾海底隧道工程
- 3. 南京圆形盾口井工程
- 4. 徐州地铁二号线一期工程
- 5. 咬合桩开挖后效果图

- 1. Fuzhou Round Intelligent Parking Lot Project
- 2. Dalian Bay Undersea Tunnel Project
- 3. Nanjing Round Shield Well Project
- 4. Xuzhou 2# metro line first-stage project
- 5. The effect diagram of secant pile after excavating

- 1
- 2
- 3
- 4
- 5

- 1. 上海武陵南路隧道拔桩施工
- 2. 上海市塘桥渡口泵站清障施工
- 3. 南通市地铁二号线拔桩清障施工
- 4. 宁波市轨道交通4号线清障施工
- 5. 上海宝山区隧道拔桩施工

灌注桩

Cast in place pile



配合旋挖钻机
With rotary drilling rig



- 1
- 2
- 3
- 4

1. 贵州六安铁路灌注桩施工
2. 徐州地铁一期工程文博园站施工
3. 四川茂县太平站成兰铁路施工
4. 河池俊蒙金地王写字楼施工
1. Construction of Guizhou Liuan railway cast-in-place pile project
2. Xuzhou 2# metro line first-stage project
3. Construction of Chenglan Railway in Taiping Station, Mao County, Sichuan
4. Hechi Junmeng Jindiawang Office Building Construction

- 1
- 2
- 3
- 4
- 5

1. 山东曲阜市鲁南高铁工程
2. 沈阳长青桥快速路改造工程
3. 贵州贵阳保税区项目
4. 广东省珠海首府花园工程
5. 中交大连湾海底隧道工程
1. Shandong qufu city lunan high-speed railway project
2. Shenyang Changqing Bridge Expressway Reconstruction Project
3. Guizhou Guiyang Free Trade Zone Project Construction
4. Construction of the Zhuhai Capital Garden Project in Guangdong Province
5. Zhongjiao dalian Bay Undersea Tunnel Project



CRD2106HZ 自行走式全回转钻机
Self propelled rotary drilling machine

CRD2106HZ 自行走式全回转钻机
Self propelled rotary drilling machine

CRD2106HZ自行走式全回转全套管钻机配备有行走履带，动力站集成一体，可自行转场对桩。基板与工作装置底座上支腿油缸连接，随整机共同移动，底座离地间隙小（250mm），设备配备空气站及高压冲洗装置，可为气动工具提供动力源及设备清洗。整机行走采用无线遥控，施工主要以有线控制为主，管路连接均采用快速接头形式。

该设备配备履带装置，转场机动灵活，扭矩大，施工效率高等特点，广泛应用于道路、桥梁、码头、高层建筑、栈桥、低空环境（如涵洞、隧道）等地基基础工程施工。

CRD2106HZ self-propelled full rotary full casing drilling rig is equipped with walking crawler and integrated power station, which can be transferred to the site for pile alignment. The base plate is connected with the outrigger oil cylinder on the base of the working device, which moves together with the whole machine. The clearance between the base and the ground is small (250mm). The equipment is equipped with air station and high-pressure flushing device, which can provide power source and equipment cleaning for pneumatic tools. The whole machine adopts wireless remote control, the construction mainly adopts wired control, and the pipeline connection adopts the form of quick joint.

The equipment is equipped with crawler device, which has the characteristics of flexible transition, large torque and high construction efficiency. It is widely used in road, bridge, wharf, high-rise building, trestle, low altitude environment (such as culvert, tunnel) and other foundation engineering construction.

主要参数 MAIN PRODUCT

CRD2106HZ

主要特点 MAIN FEATURES

- 整机配置履带行走系统，不需要大吨位履带起重机吊装转场；
- 主机和动力站集成，转场不需要接拆胶管，降低非作业操作时间消耗，效率更高；
- 动力站当配重，无需额外增加配重提升整机下压力；
- 配置高压水枪和气动扳手，套管冲洗和接头拆装方便快捷，劳动强度降低；
- 配置行走无线遥控系统，轻松实现50m范围，全方位监视控制行走全过程。

- The whole machine is equipped with crawler traveling system, which does not require large tonnage crawler crane to hoist and transfer.
- Integration of main engine and power station, no need to connect and disassemble rubber hose in transit, reduce the consumption of non-operation operation time, and achieve higher efficiency;
- Power station as counterweight, no additional counterweight lifting downforce of the whole machine;
- Equipped with high pressure water gun and pneumatic wrench, casing flushing and joint disassembly are convenient and quick, and labor intensity is reduced.
- Configuration of remote control system for walking, easy to achieve a range of 50 meters, omni-directional monitoring and control of the whole process of walking.



DCP1005H低净空全回转式全套管钻机 DCP1005H Low Clearance Full Casing Rotary Drilling Rig

低净空全回转式全套管钻机是上工机械研发的一款新型钻机，主要用于隧道、桥梁涵洞等狭小作业空间内桩基础施工。成桩直径覆盖500~1000mm，最大成桩深度40m，可满足宽4m、高4.8m隧道内作业的苛刻条件。

DCP1005H钻机由主机和动力站两部分组成，两者均配置履带行走系统，转场灵活、对桩便捷。工作时，动力站通过液压胶管、反力叉与主机连接，为主机输出动力和提供回转反扭矩。动力站采用大功率电驱动具有零排放、无噪音的优点同时自带取土装置，无需附加设备即可实现取土成桩。

The DCP1005H tunnel type casing rotator is a new type of drilling machine developed by Xuzhou Dunan Heavy Industry Machinery Manufacturing Co., Ltd. It is mainly used for pile foundation construction in narrow and much limited spaces such as tunnels and bridge culverts. The pile diameter covers 500-1000mm, and the maximum pile depth is 40m, which can meet the harsh tunnel operation condition of 4m wide and 4.8m high.

The DCP1005H casing rotator consists of two parts: the working device and the power station. Both of them are equipped with crawler walking systems, which are flexible in transition and convenient for aligning piles to the location. During operation, the power station is connected to the working device through a hydraulic hose and a reaction fork to output power and provide strong rotary torque for the working device. The power station adopts high-power electric drive with the advantages of zero discharge and no noise. At the same time, it equipped with earth-moving device, with which the device can borrow the soil without additional equipment.

主要型号 MAIN PRODUCT

DCP1005H

施工工艺 CONSTRUCTION TECHNOLOGY

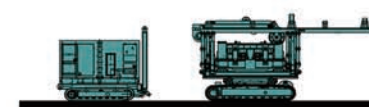

步骤一：设备进场、对桩心
Step 1: Set the equipment into the site and align with the pile core.



步骤二：连接反力叉和动力站
Step 2: Counterforce fork is coupled to the power station

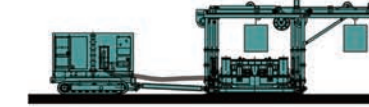

步骤三：吊装套管
Step 3: emplacement hole

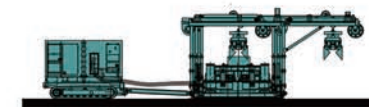

步骤四：钻进、取土
Step 4: drilling, earth borrowing

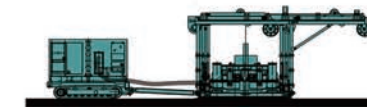

步骤五：下钢筋笼和导管
Step 5: Set reinforcement cage and catheter

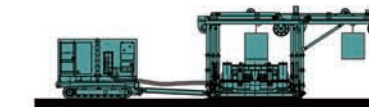

步骤六：灌注混凝土后，拔套管
Step 6: After concreting, then pulling casing pipes out



CRD2106HZ 自行走式全回转钻机

Self propelled rotary drilling machine

工作装置主要技术参数:

钻孔直径	mm	Ø1000~ Ø2100
回转扭矩	kN·m	3085/1823/1030瞬时3505
回转速度	rpm	0.9/1.5/2.7
套管下压力	kN	最大600
套管起拔力	kN	3760瞬间4300
压拔行程	mm	500
行走速度	km/h	0~1.5
爬坡能力		13°
行走离地高度	mm	250
重量	ton	69 (整机)

The main technical parameters of base machine:

Diameter of drill hole	mm	Ø1000~ Ø2100
Rotary torque	kN·m	3085/1823/1030 Instantaneous 3505
Rotary speed	rpm	0.9/1.5/2.7
Lower pressure of sleeve	kN	Max.600
Puling force of sleeve	kN	3760 Instantaneous 4300
Pressure-pulling stroke	mm	500
Walking speed	km/h	1.5
Climbing ability		13°
Walking height from the ground	mm	250
Weight	ton	69 (Complete machine)

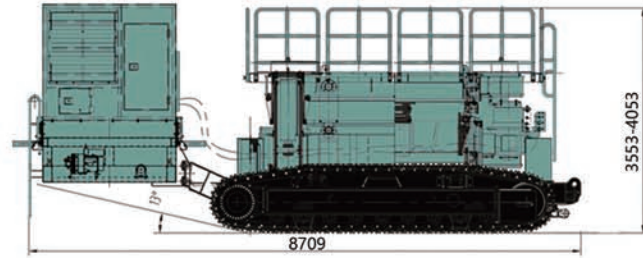

液压动力站主要技术参数:

发动机型号	康明斯 QSM11-335
发动机功率	kW/rpm 272/1800
燃油消耗率	g/kWh 216
液压空压机排量	m³/h 1.3
液压空压机压力	bar 12
冲洗装置压力	Mpa 12
选配	空压机、冲洗装置
控制方式	有线遥控/无线遥控

Major technical parameters of hydraulic power pack:

Engine model	Cummins QSM11-335
Engine power	kW/rpm 272-1800
Fuel consumption rate	g/kWh 216
Displacement of hydraulic air compressor	m³/h 1.3
Hydraulic air compressor pressure	bar 12
Pressure of flushing device	Mpa 12
Matching	Air compressor/flushing device
control mode	Wired remote control/wireless remote control

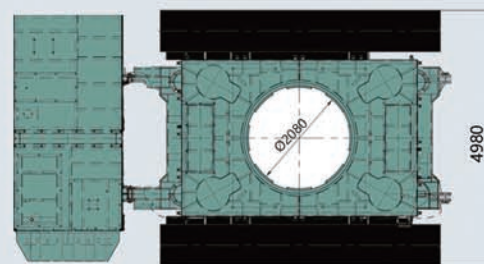

DCP1005H 低净空全回转式全套管钻机

Low Clearance Full Casing Rotary Drilling Rig

工作装置主要技术参数:

钻孔直径	mm	Ø500~ Ø1000
回转扭矩	kN·m	845/525/290瞬时1050
回转速度	rpm	4.15/2.3/1.25
套管下压力	kN	最大300
套管起拔力	kN	2411瞬间2733
压拔行程	mm	450
重量	ton	31

The main technical parameters of base machine:

Diameter of drill hole	mm	Ø500~ Ø1000
Rotary torque	kN·m	845/525/290 Instantaneous 1050
Rotary speed	rpm	4.15/2.3/1.25
Lower pressure of sleeve	kN	Max.300
Puling force of sleeve	kN	2411 Instantaneous 2733
Pressure-pulling stroke	mm	450
Weight	ton	31

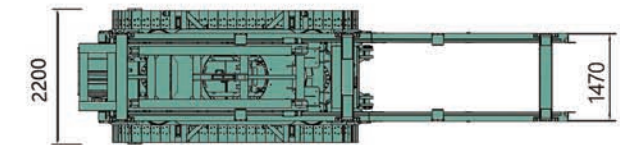
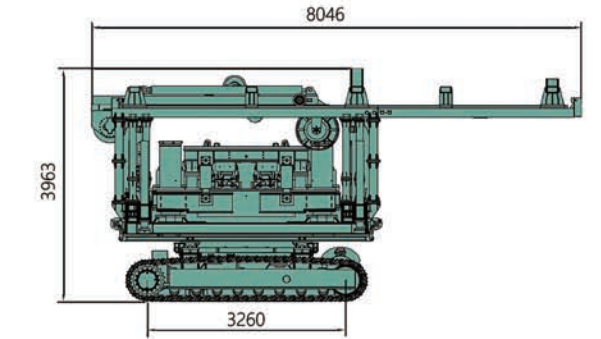

液压动力站主要技术参数:

电动机型号	YE2-315S-4 YE2-280M-4 YM-132M-4
电动机功率	kw 207.5(110+90+7.5)
重量	ton 10
控制方式	10 有线遥控+无线遥控

Major technical parameters of hydraulic power pack:

Electromotor model	YE2-315S-4 YE2-280M-4 YM-132M-4
Electromotor power	kw 207.5(110+90+7.5)
weight	ton 10
control mode	Wired remote control + wireless remote control



DBG系列全液压拔管机 DBG Series Full Hydraulic Pipe Puller

拔管机是各类岩土钻掘工程中钻机的配套辅助设备，适用于跟管钻进工艺施工，用于起拔钻孔护壁套管，也可用于钻具事故处理中起拔套管；配合全回转、搓管机、旋挖钻等进行拔管作业，能有效提升施工效率。DBG系列拔管机具有结构紧凑，起拔力强，夹紧力大，安全可靠，反应灵活，操作维护简单、方便等优点。

Pipe-pulling machine is the auxiliary equipment of drilling rigs in various geotechnical drilling projects. It is suitable for following-pipe drilling process construction, for pulling out wall casing of drilling holes, and for pulling out casing in drilling tool accident treatment. Pipe-pulling operation with full rotation, pipe-rubbing machine and rotary drilling can effectively improve construction efficiency. DBG series pipe puller has the advantages of compact structure, strong pulling force, large clamping force, safety and reliability, flexible response, simple operation and maintenance, and convenience.



产品型号 PRODUCT MODEL

DBG1300 / DBG1600 / DBG2100 / DBG2500

主要特点 MAIN FEATURES

- 起拔力强，更适合大深度套管起拔；
 - 夹紧力大，大缸径、多油缸夹紧，不会出现传统拔管机套管打滑现象；
 - 动力配置更合理，双电机液压驱动，依次启动，对工地电力配置要求低，低噪音、低能耗；
 - 拆装更方便，主机和动力站之间液压胶管配置快速接头，比传统拔管机螺纹接头拆装更快捷；
 - 安全性更高，配置灌注桩拔管操作台和安全护栏，相比传统拔管机更符合安全规范；
 - 配置无线遥控，DBG系列拔管机采用无线遥控技术，实现50m内，360°无死角观察和操作。
-
- Strong pull-out force, more suitable for large depth casing pull-out;
 - Large clamping force, large cylinder diameter, multi-cylinder clamping, there will be no slip-page phenomenon of traditional pipe puller casing;
 - Power configuration is more reasonable, dual motor hydraulic drive, start in turn, low requirements for site power configuration, low noise, low energy consumption;
 - It is more convenient to disassemble and assemble. The hydraulic hose between the main engine and the power station is equipped with quick joint, which is faster than the traditional thread joint of the pipe puller.
 - Safety is higher, equipped with cast-in-place pile pipe-pulling operation table and safety guardrail, which is more in line with safety standards than traditional pipe-pulling machine.
 - Configuration of wireless remote control, DBG series pipe extruder using wireless remote control technology, to achieve within 50 meters, 360 degrees no dead angle observation and operation.



DBG1300 全液压拔管机

Full Hydraulic Pipe Drawing Machine

工作装置主要技术参数:

拔管范围	mm	Ø600~ Ø1300
夹紧油缸行程	mm	235
最大起拔力	kN	3600
起拔行程	mm	600
最大起拔速度	mm/s	25
重量	ton	8

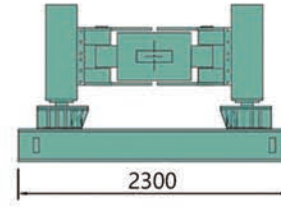
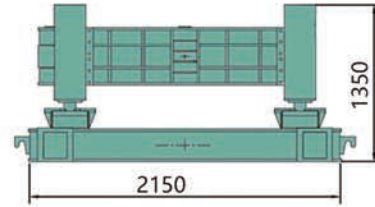

The main technical parameters of base machine:

Extubation range	mm	Ø600~ Ø1300
Clamping cylinder stroke	mm	235
Maximum pull-out force	kN	3600
Up and down journey	mm	600
Maximum pull-out speed	mm/s	25
Weight	ton	8

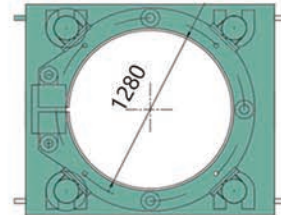

DBG1600 全液压拔管机

Full Hydraulic Pipe Drawing Machine

工作装置主要技术参数:

拔管范围	mm	Ø800~ Ø1600
夹紧油缸行程	mm	235
最大起拔力	kN	4500
起拔行程	mm	600
最大起拔速度	mm/s	22
重量	ton	10

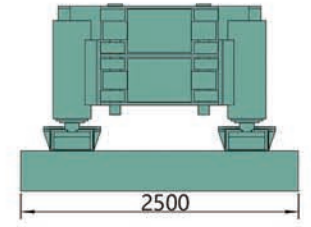
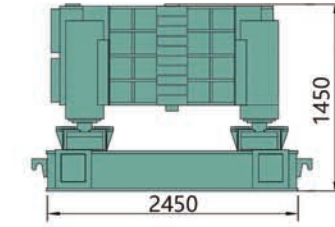

The main technical parameters of base machine:

Extubation range	mm	Ø800~ Ø1600
Clamping cylinder stroke	mm	235
Maximum pull-out force	kN	4500
Up and down journey	mm	600
Maximum pull-out speed	mm/s	22
Weight	ton	10

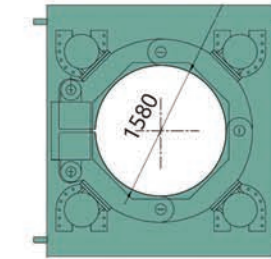

液压动力站主要技术参数:

电机型号		YE2-250M-4
电机功率	kW	55
系统压力	MPa	30
液压油箱容积	L	600
重量	ton	3
控制方式		无线遥控

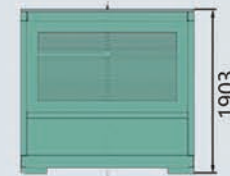
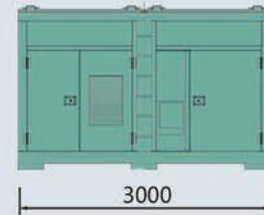

Major technical parameters of hydraulic power pack:

Motor Model		YE2-250M-4
Motor power	kW	55
System pressure	MPa	30
Fuel tank volume	L	600
weight	ton	3
Control mode		Wireless remote control

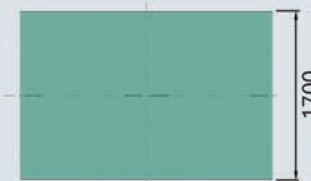

液压动力站主要技术参数:

电机型号		YE2-250M-4
电机功率	kW	55
系统压力	MPa	30
液压油箱容积	L	600
重量	ton	3
控制方式		无线遥控

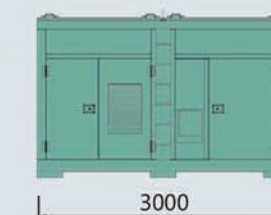

Major technical parameters of hydraulic power pack:

Motor Model	kW	YE2-250M-4
Motor power	MPa	55
System pressure	L	30
Fuel tank volume	ton	600
weight		3
Control mode		Wireless remote control



DBG2100 全液压拔管机

Full Hydraulic Pipe Drawing Machine

工作装置主要技术参数:

拔管范围	mm	Ø1000~ Ø2100
夹紧油缸行程	mm	160
最大起拔力	kN	6000
起拔行程	mm	600
最大起拔速度	mm/s	36
重量	ton	21

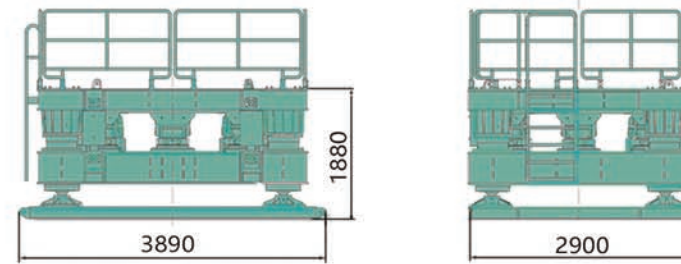

The main technical parameters of base machine:

Extubation range	mm	Ø1000~ Ø2100
Clamping cylinder stroke	mm	160
Maximum pull-out force	kN	6000
Up and down journey	mm	600
Maximum pull-out speed	mm/s	36
Weight	ton	21

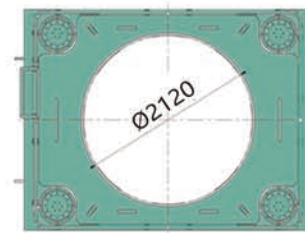

DBG2500 全液压拔管机

Full Hydraulic Pipe Drawing Machine

工作装置主要技术参数:

拔管范围	mm	Ø1200~ Ø2500
夹紧油缸行程	mm	180
最大起拔力	kN	8000
起拔行程	mm	600
最大起拔速度	mm/s	22
重量	ton	25

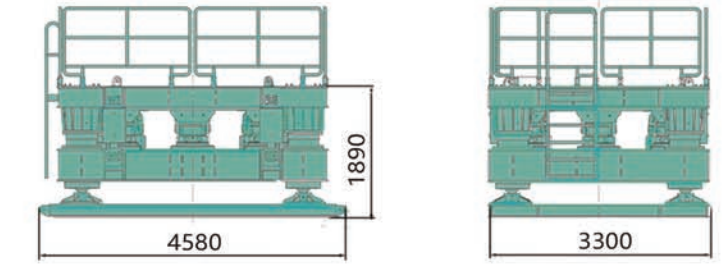

The main technical parameters of base machine:

Extubation range	mm	Ø1200~ Ø2500
Clamping cylinder stroke	mm	180
Maximum pull-out force	kN	8000
Up and down journey	mm	600
Maximum pull-out speed	mm/s	22
Weight	ton	25

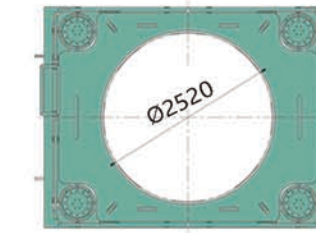

液压动力站主要技术参数:

电机型号		YE2-250M-4
电机功率	kW	110 (55kW*2)
系统压力	MPa	30
液压油箱容积	L	750
重量	ton	4
控制方式		无线遥控

Major technical parameters of hydraulic power pack:

Motor Model		YE2-250M-4
Motor power	kW	110 (55kW*2)
System pressure	MPa	30
Fuel tank volume	L	750
weight	ton	4
Control mode		Wireless remote control



液压动力站主要技术参数:

电机型号		YE2-250M-4
电机功率	kW	110 (55kW*2)
系统压力	MPa	30
液压油箱容积	L	750
重量	ton	4
控制方式		无线遥控

Major technical parameters of hydraulic power pack:

Motor Model	kW	YE2-250M-4
Motor power	MPa	110 (55kW*2)
System pressure	L	30
Fuel tank volume	ton	750
weight		4
Control mode		Wireless remote control

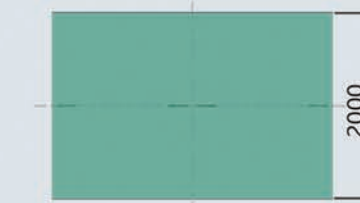
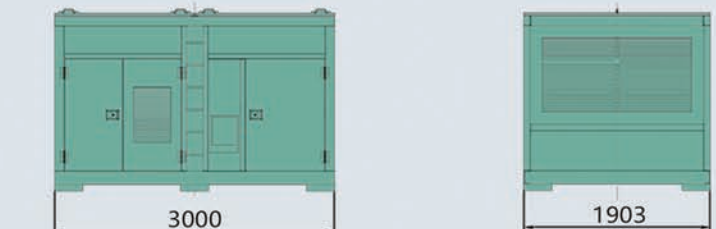

DAG系列钢立柱植入设备 DAG Steel Column Implant Device



产品介绍 / DAG系列钢立柱植入设备
PRODUCT OVERVIEW / DAG Steel Column Implant Device

DAG系列钢立柱植入设备 DAG Steel Column Implant Device

DAG系列钢立柱植入设备是一种新型钢立柱施工设备，主要用于深层开挖、软弱地层开挖和靠近建筑物施工的盖挖逆作法。DAG系列钢立柱植入设备配置两套楔形液压夹紧装置和高精度垂直控制系统，既可以将钢立柱植入到初凝前的混凝土中，也可以先植钢立柱再浇混凝土。一台设备轻松办办两种钢立柱施工工艺，解决了传统钢立柱施工配套设备多、精度低、成本高、效率慢等缺点。



DAG series steel column implantation equipment is a new type of steel column construction equipment, which is mainly used for deep excavation, soft ground excavation and construction close to buildings. DAG series steel column implantation equipment is equipped with two sets of wedge-shaped hydraulic clamping device and high precision vertical control system, which can not only implant steel column into concrete before initial setting, but also plant steel column before pouring concrete. One equipment can easily arrange two kinds of steel column construction technology, which solves the shortcomings of traditional steel column construction supporting equipment, low precision, high cost, slow efficiency and so on.

产品型号 PRODUCT MODEL

DAG1300 / DAG1600

主要特点 MAIN FEATURES

- 主机重量轻，对配套起重机要求更低；
- 楔块式夹紧，主副夹紧同为数控机床制作的楔形抱紧装置，同轴精度更高；
- 行业首创三油缸副夹紧技术，联动状态高度同步；
- 施工不需要辅助夹紧平台，钢立柱植入垂直精度提升20%；
- 电驱动液压动力系统，低噪音，低能耗，环保经济；
- 配置无线控制系统，操作者可在0-50m范围内360°无死角监控钢立柱植入全过程。



- The main engine is light in weight and has lower requirements for supporting cranes.
- Wedge-block clamping, the main and auxiliary clamping device is the same as the wedge-shaped clamping device made for CNC machine tools, and the coaxial precision is higher.
- The industry pioneered the technology of three-cylinder pair clamping, and the linkage state is highly synchronous.
- No auxiliary clamping platform is needed for construction, and the vertical accuracy of steel column implantation is increased by 20%.
- Electrically driven hydraulic power system, low noise, low energy consumption, environmental protection and economy;
- With wireless control system, the operator can monitor the whole process of steel column implantation without dead angle in the range of 0-50m.

DAG1300 钢立柱植入设备

Steel Column Implantation Equipment

工作装置主要技术参数:

变径范围	mm	Ø600~ Ø1300
夹紧行程	mm	200
最大下压力	kN	800
压拔行程	mm	750
最大下压速度	mm/s	55
重量	ton	22

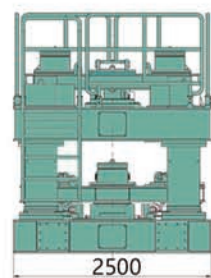
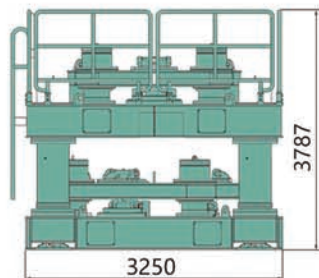

The main technical parameters of base machine:

Variable diameter range	mm	Ø600~ Ø1300
Clamping stroke	mm	200
MaxDownward pressure	kN	800
Drawing stroke	mm	750
MaxDownward pressure velocity	mm/s	55
Weight	ton	22

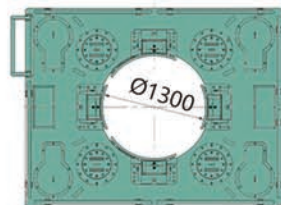

DAG1600 钢立柱植入设备

Steel Column Implantation Equipment

工作装置主要技术参数:

变径范围	mm	Ø800~ Ø1600
夹紧行程	mm	200
最大下压力	kN	1000
压拔行程	mm	750
最大下压速度	mm/s	55
重量	ton	24

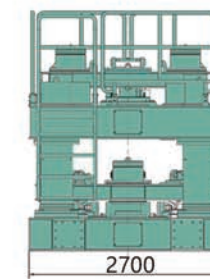
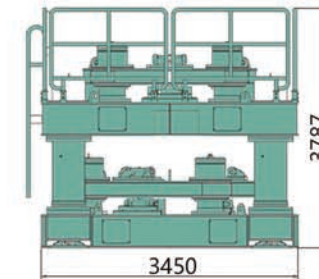

The main technical parameters of base machine:

Variable diameter range	mm	Ø800~ Ø1600
Clamping stroke	mm	200
MaxDownward pressure	kN	1000
Drawing stroke	mm	750
MaxDownward pressure velocity	mm/s	55
Weight	ton	24

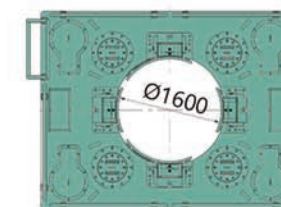

液压动力站主要技术参数:

电机型号	YE2-225S-4
电机功率	kW 37
系统压力	MPa 25
液压油箱容积	L 700
重量	ton 3.5
控制方式	无线遥控

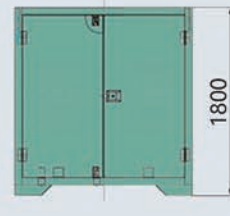
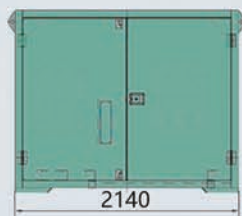

Major technical parameters of hydraulic power pack:

Motor Model	YE2-225S-4
Motor power	kW 37
System pressure	MPa 25
Fuel tank volume	L 700
weight	ton 3.5
Control mode	Wireless remote control

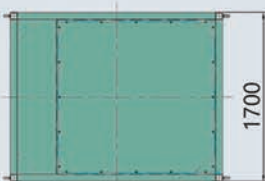

液压动力站主要技术参数:

电机型号	YE2-225M-4
电机功率	kW 45
系统压力	MPa 25
液压油箱容积	L 800
重量	ton 4
控制方式	无线遥控

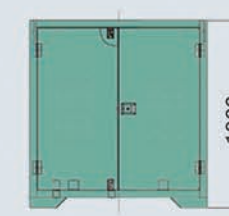
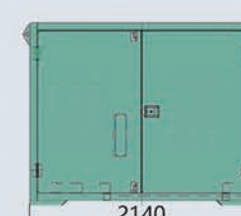

Major technical parameters of hydraulic power pack:

Motor Model	kW YE2-225M-4
Motor power	MPa 45
System pressure	L 25
Fuel tank volume	ton 800
weight	4
Control mode	Wireless remote control



专业服务 创造价值

1、服务接待

24小时开通免费服务热线4008881749，全天候为客户提供产品咨询、服务受理；如果您对我们的产品感兴趣，我们的销售人员会耐心地接待您，亦可免费上门为您提供相关咨询及介绍。

1、FREE-CALL CENTER SERVICE

We provide free-call center service for 24hours. For further information of SEMW products or after-sale service, please call us at+0086-21-4008881749. We will provide information or solutions you need.

2、咨询方案

施工过程中，遇疑难问题，免费提供技术咨询；我们拥有一支经验丰富的工程师团队，根据您实际的施工要求、地质情况，为您量身定制更合理的解决方案。

2、CONSULTANCY & SOLUTIONS

Our professional team offers free consulting services according to different job sites, soil conditions and your requirements.

3、调试培训

免费指导安装调试产品，直至产品交付正常使用；如有需要，可提供有偿现场施工工艺指导及培训，确保设备操作人员掌握设备的正确使用方法、保养要求及常见故障的正确诊断和排除方法。

3、TESTING & TRAINING

SEMWW is committed to free guidance of installation and testing, to make sure that you can make proper operations. We will offer training on site if it is necessary, to make sure you know the correct way for maintenance, analysis and debugging of the malfunctions.

4、维修保养

经验丰富的专业服务工程师队伍时刻待命，随时响应客户的服务需求。公司自主生产并供应配件，易损件供货充足，服务响应速度远远快于国外进口产品。定制化年度维保方案，确保设备时刻处在最佳状态，让客户高枕无忧。

4、MAINTENANCE & REPAIR

We have offices in many places in China, easy for maintenance. Sufficient supplies for spare parts and wearing parts. Our service team has a wide range of professional experience on any size project large or small. They provide best solutions with quick response.

5、回访维系

呼叫中心100%服务记录回访，定期进行客户满意度调查；客户俱乐部定期为您提供更新产品、分享更全面技术信息、享受更多优惠服务。

5、CUSTOMERS & CONNECTIONS

After-sale customer file was set up for better understanding your need and feedback. More services are provided, such as, sending info of new released products, latest technology. We also provide special offer for you.

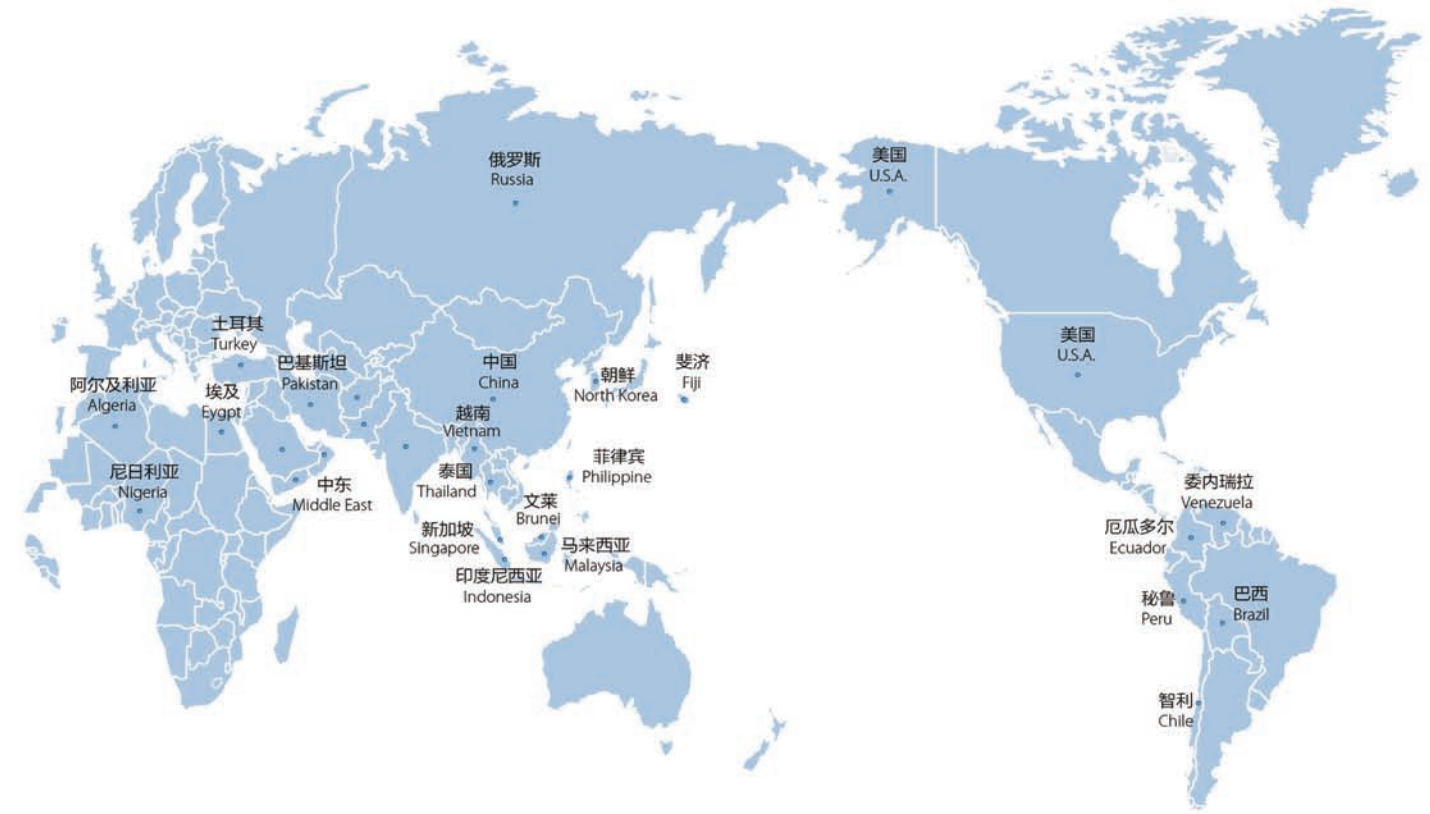

全球营销网络

THE GLOBAL MARKETING NETWORK

上工机械不仅仅在国内具有良好的市场声誉；产品批量出口欧洲及俄罗斯，全面覆盖东南亚、成功推广至南北美市场，在非洲市场也拥有广泛且固定的客户群。

SEMWW has achieved a good reputation domestically and overseas. SEMWW products are exported in a large quantity to Europe, Russia, Southeast Asia, North America, South America, and Africa.